

41—Writing Desk

This is probably the most difficult problem in cabinet-making in this book but the desk may be satisfactorily constructed by high school pupils of unusual ability. The problem of paneling in front and back (the same in each) is a good test of technical skill. The lower part of the front when lowered to a horizontal position, catches under the middle shelf and forms the writing table. The back and top are fastened in position by method described in the notes on the sewing cabinet. The bichromate of potash finish or some dark stain will be suitable. If the stain is one that is on the wood instead of in it a covering of shellac or varnish should be used.



42—Bookcase

A high school problem. There is introduced in this project the problem of glass paneling and leaded glass work. The back is made in two panels similar to the doors without the middle one-inch stiles. The ends should be glued up first and the case set up as described in notes on music cabinets.

WRITING DESK

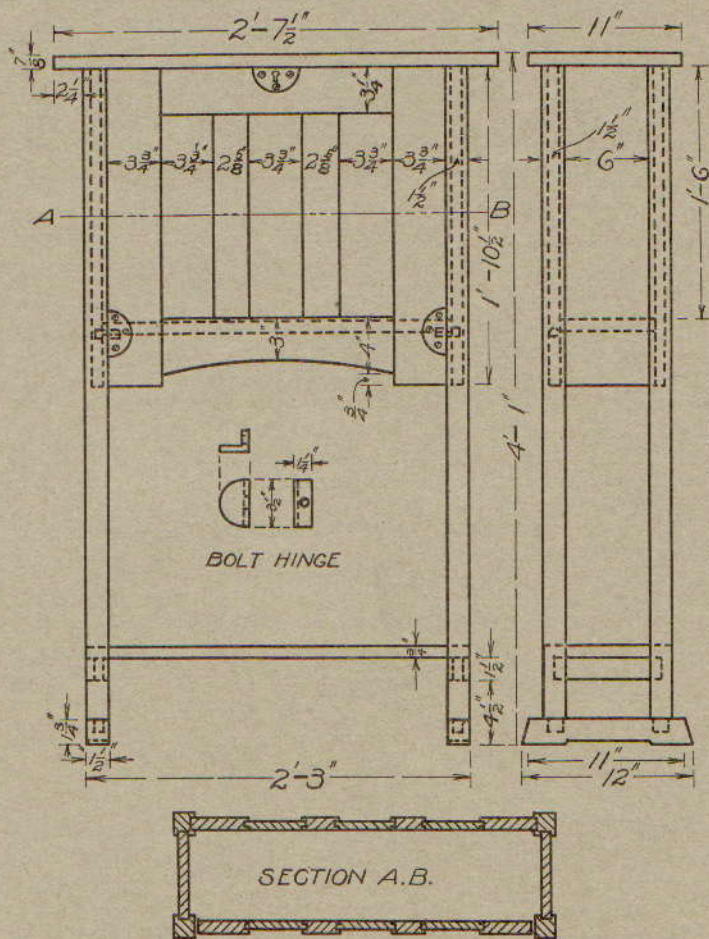

WRITING DESK INTERIOR

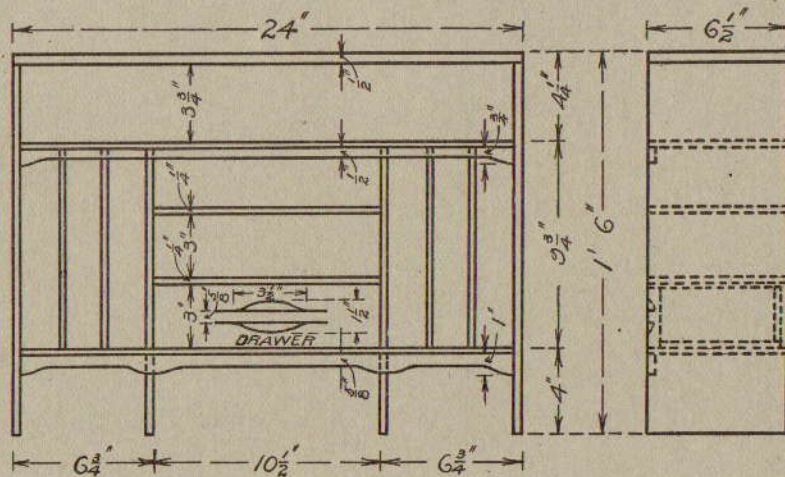

BOOK CASE

